

Permentry Door & Stairs

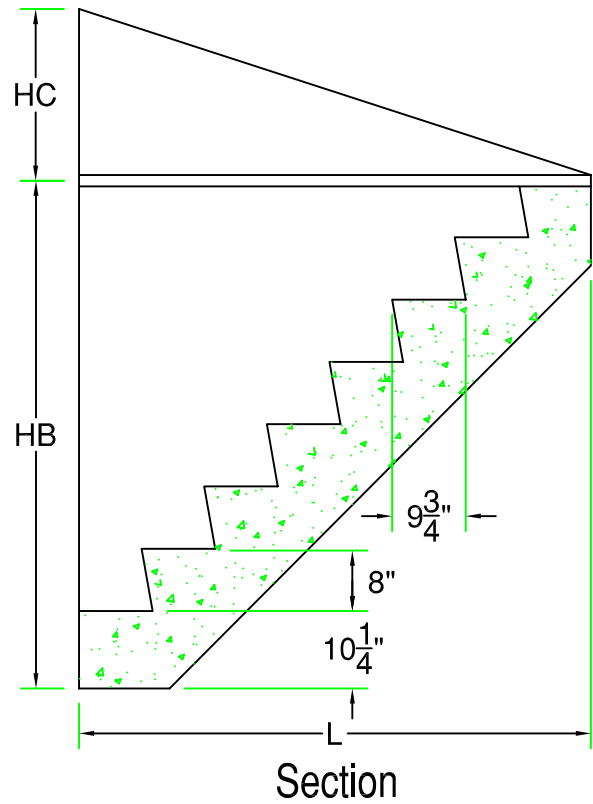

TYPE	W (WIDTH)	L (LENGTH)	HEIGHT			Precast (LBS)
			HA (TOTAL)	HB (PRECAST)	HC (DOOR)	
S	51 1/2"	45"	95"	43"	52"	2,400
O	51 1/2"	60"	90"	60"	30"	3,600
B	55 1/2"	66"	90"	68"	22"	4,800
C	55 1/2"	74"	95 1/2"	76"	19 1/2"	5,500
D	55 1/2"	86"	106"	84"	22"	6,200
E	58"	95 1/2"	115"	93"	22"	7,800
F	58"	104"	123"	101"	22"	9,000

- Optional Door Lock Available
- Heavy Double Leaf Bilco Steel Doors

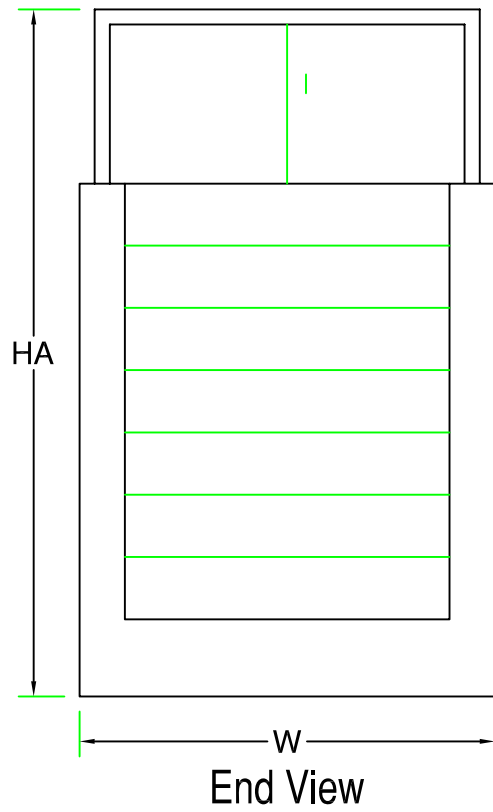
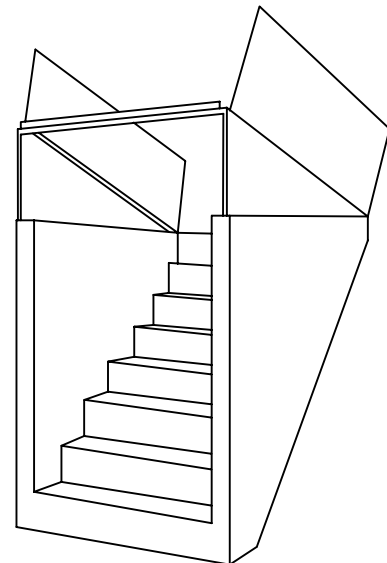

SPECIFICATIONS:

- Concrete Minimum Strength 5000psi @ 28 days
- Steel Reinforcement Grade 60
- Weights Subject to Variation



PRECAST CONCRETE PRODUCTS
78 PRECAST ROAD MILTON, VT 05468 +802.893.2401
TOLL FREE 1.888.299.2401 FAX 802.893.1542